

T.E.T.[®] THESE = THOSE

#2 Neutral Floor Cleaner

®

SAFE DATA

PRODUCT DESCRIPTION:

Specially designed to safely clean finished floors. Leaves no dulling residue to haze or harm the finish gloss. Autoscrubber application requires no additional mopping and produces very little foam in recovery tanks.

FEATURES:

Environmentally Friendly:

Neutral Floor Cleaner is a concentrate that is non-flammable and contains no harsh alkalis. It has a neutral pH.

Reduces Labor:

Reduces equipment downtime. Produces very little foam in automatic scrubber recovery tanks and requires no additional mopping.

Cost Effective:

Ultra concentrated, one 32 ounce bottle makes 128 gallons of mopping solution and 256 gallons of scrubbing solution. **Neutral Floor Cleaner** reduces storage space and eliminates waste.

PRODUCT SPECIFICATIONS:

pH	8.0 ± 0.5
Appearance	Red Liquid
Fragrance	Citrus
Freezing Point	About 32°F
Solubility in Water	Complete
Flash Point	None to Boiling

INGREDIENTS:

Water	7732-18-5
Undeceth-7	34398-01-1
Potassium EDTA	5964-35-2
Sodium xylene sulfonate	1300-72-7
Fragrance	Mixture

ECOLOGICAL INFORMATION:

- Biodegradable Surfactants
- Neutral pH
- Contains no Phosphorus
- Low VOC

DILUTIONS	HEALTH	FLAMMABILITY	REACTIVITY
CONCENTRATE CONCENTRAR	NFPA 1 HMIS	NFPA 0 HMIS	NFPA 0 HMIS
(1:512 RATIO) (1:512 RAZÓN)	NFPA 0 HMIS	NFPA 0 HMIS	NFPA 0 HMIS
(1:1024 RATIO) (1:1024 RAZÓN)	NFPA 0 HMIS	NFPA 0 HMIS	NFPA 0 HMIS
PROPORCIÓN	SALUD	INFLAMABILIDAD	REACTIVIDAD

0	1	2	3	4
Minimal	Slight	Moderate	Serious	Severe
Mínimo	Mínimo	Moderar	Grave	Drástico

T.E.T.® #2 Neutral Floor Cleaner

CLEANS AND LEAVES NO DULLING RESIDUE

DIRECTIONS

USE INFORMATION

Always dust mop the floor first. Remove gum, labels and other attached soil deposits with a putty knife or long handled scraper.

AUTOSCRUBBER DIRECTIONS



1. REMOVE CAP 2. SQUEEZE 3. POUR 4. CLEAN

MOP & BUCKET DIRECTIONS

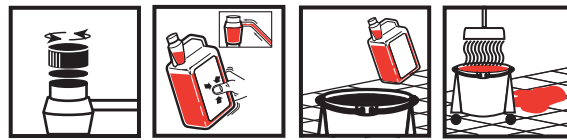

1. REMOVE CAP 2. SQUEEZE 3. POUR 4. CLEAN

DIRECTIONS

1. **REMOVE CAP** and seal.
2. **SQUEEZE BOTTLE** and fill the portion control cup. Excess cleaner will automatically flow back into the bottle.
3. **POUR** the contents of the cup into the automatic scrubber solution tank. Fill the automatic scrubber with 8 gallons of water (1:1024 ratio). In bucket, dilute one cup with 4 gallons of water (1:512 ratio).
4. **CLEAN** using an automatic scrubber or mop and bucket.

WARNING

Causes eye irritation. May cause skin irritation. Harmful to aquatic life. Harmful to aquatic life with long lasting effects.

Prevention

Wash thoroughly after handling. Avoid release to the environment.

Response

If in eyes: Rinse cautiously with water for several minutes. Remove contact lenses, if present and easy to do. Continue rinsing. If eye irritation persists: Get medical advice / attention.

Storage

Store away from incompatible materials.

Disposal

Dispose of contents/container in accordance with local / regional / national / international regulations.

PERSONAL PROTECTION:

Respiratory Protection: Not needed under normal conditions.

Ventilation: Use with adequate ventilation.

Eye Protection: Safety glasses are recommended.

Protective Gloves: Protective gloves are optional.

Other Protective Clothing or

Equipment: Wear clothing as necessary to prevent skin contact.

TRANSPORTATION

INFORMATION:

U.S. DOT - Proper Shipping

Name: Not regulated by DOT.

Marine Pollutant: No

Franklin Cleaning Technology

One Fuller Way

Great Bend, KS 67530

United States

CHEMTREC (800) 424-9300

Emergency (620) 792-1711

24 hour Emergency (800) 424-9300

www.fullercommercial.com