



SPRAY 'n AWAY

Ready-To-Use All Purpose Cleaner

PRODUCT DESCRIPTION:

Spray 'n Away Ready to Use is a fast acting Non-butyl all-purpose cleaner for use on any hard surface. A blend of detergents and solvents that is excellent for removing wax, grease, oil, dirt, tobacco and grime. No mixing no diluting, ready-to-use. The improved formula creates a stable foam that will really cling to vertical surfaces and improve cleaning quality.

FEATURES:

Reduces Labor:

Gets tough cleaning jobs done quickly. Reduces cleaning time and lowers maintenance costs. Rinses quickly and completely with water.

High Foaming Formula:

Added foaming action results in a cling foam that improves contact time and more thorough cleaning for vertical surfaces.

Environmentally Friendly:

All surfactants are biodegradable and safe for disposal in sewer systems and septic tanks.

Ready To Use:

No mixing or diluting required. Simple, convenient, easy to use package stores easily and is always ready-to-use.

PRODUCT SPECIFICATIONS:

pH	12.0
Appearance	Light Blue Slightly Hazy
Fragrance	Sassafras
Freezing Point	About 32°F
Solubility in Water	Complete
Flash Point	None

INGREDIENTS:

Water	7732-18-5
Dipropylene glycol n-propyl ether	29911-27-1
Cocamidopropyl hydroxy Sultaine	68139-30-0
Sodium xylene sulfonate	1300-72-7
Sodium Metasilicate	6834-92-0

PRODUCT AVAILABILITY:

- 901512/32 oz. bottles

END-USE-RATING

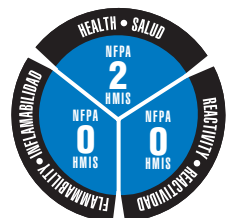

0	1	2	3	4
Minimal	Slight	Moderate	Serious	Severe
Minimo	Minimo	Moderar	Grave	Drastico

DATA SHEET

FULLPRO
FULLER PROFESSIONAL

SPRAY 'N AWAY

RTU ALL PURPOSE CLEANER



USE INFORMATION: Recommended for cleaning hard surfaces such as walls, floors, baseboards, stoves, vent hoods, metal office furniture and vinyl upholstery.

CLEANING

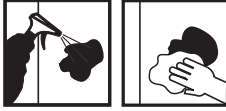

1. SPRAY

2. WIPE

DIRECTIONS FOR USE:

1. **Spray** 6 to 8 inches from cleaning surface or apply with a damp sponge.
2. **Wipe** clean.

NOTE: Permanent damage will result if Spray 'n Away is allowed to remain or dry on glass, aluminum or varnish surfaces. Rinse food contact surfaces with potable water prior to reuse.

Authorized by USDA for use in Federally inspected meat and poultry plants.

FIRST AID:

If in eyes or skin, flush with water for 15 minutes while removing contaminated clothing and shoes. Get medical attention if irritation persists. Wash clothing and thoroughly clean shoes before reuse.

WARNINGS:

EYE IRRITANT. Avoid contact with eyes, skin and clothing. Wash thoroughly after handling. In confined areas use with appropriate protective equipment.

HANDLING AND STORAGE:

SUGGESTED STORAGE TEMPERATURE: Store inside at 40-90°F. **SPECIAL HANDLING AND STORAGE:** Handle in accordance with good industrial hygiene and safety practices. These practices include avoiding unnecessary exposure and removal of material from eyes, skin and clothing. Store in a cool, dry, ventilated area. Protect from freezing. Thoroughly rinse empty containers.

KEEP OUT OF REACH OF CHILDREN

PERSONAL PROTECTION:

Respiratory Protection: Not needed under normal conditions. Do not spray in confined areas.

Ventilation: Use with adequate ventilation.

Eye Protection: Safety glasses are recommended.

Protective Gloves: Protective gloves are recommended.

Other Protective Clothing or Equipment: Wear clothing as necessary to prevent skin contact.

TRANSPORTATION INFORMATION:

U.S. DOT - Proper Shipping Name: Not regulated by DOT.

Marine Pollutant: No

DATA SHEET

FULLPRO
FULLER PROFESSIONAL